

PRODUCT WARNING



CAUTION:  
RISK OF ELECTRIC SHOCK. DO NOT TAMPER. NO SERVICABLE PARTS INSIDE.

IMPORTANT SAFETY INSTRUCTIONS. READ ALL INSTRUCTIONS BEFORE  
INSTALLING AND USING THIS PRODUCT. KEEP IT FOR FUTURE REFERENCE.

When using electrical appliances, basic precautions should always be followed to  
reduce the risk of fire, electric shock, injury to persons, and hyperthermia, including  
the following:

1. This heater is hot when in use. To avoid burns, do not let bare skin touch hot surfaces. If provided, use handles when moving this heater. Keep combustible materials, such as furniture, pillows, bedding, papers, clothes, and curtains at least 3 feet (0.9 m) from the front of the heater and keep them away from the sides and rear.
2. Extreme caution is necessary when any heater is used and whenever the heater is left operating and unattended. This heater is not intended for persons (including children) with reduced physical, sensory, or mental capabilities, or a lack of experience with and knowledge, unless they have been given supervision or instruction concerning the use of the appliance by a person responsible for their safety.
3. Always unplug heater when not in use. This item may be omitted if the heater is provided with a clock-operated switch.
4. Do not operate any heater with a damaged cord or plug or after the heater malfunctions, has been dropped or damaged in any manner. Discard heater or return to an authorized service facility for examination and/or repair.
5. Do not use outdoors.
6. This heater is not intended for use in bathrooms, laundry areas, and similar indoor locations. Never place heater where it may fall into a bathtub or other water containers.

1

PRODUCT WARNING

7. Do not run cords under carpeting. Do not cover cords with throw rugs, runners, or similar coverings. Do not route cords under furniture or appliances. Arrange cords where it will not be tripped over and away from traffic areas.
8. To disconnect heater, turn controls to OFF, then remove plug from outlet.
9. Do not insert or allow foreign objects to enter any ventilation or exhaust openings as this may cause an electric shock or fire or damage the heater.
10. To prevent a possible fire, do not block air intakes or exhausts in any manner. Do not use on soft surfaces, like a bed, where openings may become blocked.
11. A heater has hot and arcing or sparking parts inside. Do not use it in areas where gasoline, paint, or flammable liquids are used or stored.
12. Use this heater only as described in this manual. Any other use not recommended by the manufacturer may cause fire, electric shock, or injury to persons.
13. Always plug heaters directly into a wall outlet/receptacle. Never use with an extension cord or relocatable power tap (outlet/power strip).
14. Hyperthermia can result in death. Symptoms of hyperthermia include high body temperature, headache, nausea, vomiting, tiredness, dizziness, fainting, and rapid pulse. If you begin to experience symptoms related to hyperthermia, turn off the heater and seek medical attention.
15. To avoid excessive room temperatures which can cause hyperthermia, DO NOT leave product running unattended in a confined space around infants or individuals with reduced physical, sensory, or mental capabilities.
16. Make sure that no pieces of polystyrene or other packaging material have been left between elements of this product. It may be necessary to pass over this product with a vacuum cleaner. Dispose of all packaging and product materials in an environmentally responsible manner.

2

PRODUCT WARNING

17. Choking Hazard - this product may contain small parts. Keep away from children. If small parts are swallowed, seek medical attention at once.
18. Prior to cleaning, storage, or any time when this product is not in use, turn off the power and unplug the cord to allow it to cool. Clean this product regularly, only as instructed in this manual. Do not use gasoline, thinners, solvents, ammonias, or other chemicals for cleaning.
19. There may be a trace of smoke or odor when this product is first operated. This indicates that a drop of oil fell on the heating coil during the manufacturing process. It will quickly evaporate and should not reoccur.
20. IMPORTANT - This product may have a US polarized plug (one blade is wider than the other). To reduce the risk of electric shock, this plug is intended to fit in a polarized outlet only one way. If the plug does not fit fully in the outlet, reverse the plug. If it still does not fit, contact a qualified electrician. Do not attempt to tamper with this safety feature.

DO NOT attempt to repair this product yourself!

All service and/or repairs must be done by an authorized technician and/or electrician. Contact our customer service department at [support@acinfinity.com](mailto:support@acinfinity.com) or 626-923-6399 for product and warranty assistance.

DANGER - High temperatures may be generated under certain abnormal conditions. Do not partially or fully cover or obstruct the front of this heater.

READ AND SAVE THESE INSTRUCTIONS.

3

PRODUCT CONTENTS

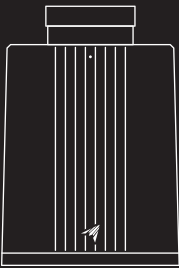

HEATER  
UNIT  
(x1)



UIS EXTENSION  
CORD (M-M)  
(x1)



WIRE  
TIE  
(x4)



HOOK &  
LOOP TIE  
(x4)

4

INSTALLATION

NO DUCTING

Place your heater to the side of your tent and direct the exhaust vent into the lower tent port.

**WARNING:** Do not operate the heater near liquids or in enclosed, high-humidity spaces to prevent risk of electric shock or fire.

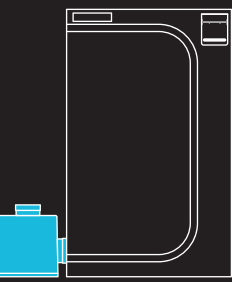

Ensure the heater body is not touching the side of the tent and is away from any flammable items.

DUCTING\*

Use 4 in. heat-resistant ducting to connect your heater to your tent. Twist your duct tube into the exhaust vent.

If you wish to use ducting for your intake vent, you may attach it with a duct clamp.

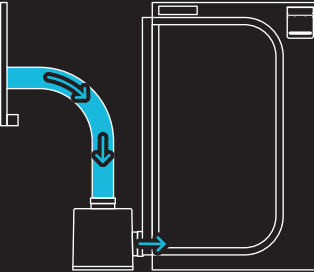

\*Not included

5

INSTALLATION

POWERING YOUR HEATER

Plug your heater's power plug into an outlet to power it.

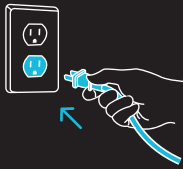

When your heater is receiving power, the light at the front of the unit will illuminate red.

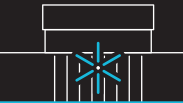

6

CLEANING

STEP 1

Turn your heater OFF before unplugging it.

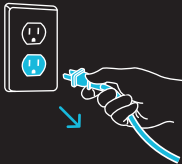

Wait for your heater to cool down before cleaning it.

STEP 2

Remove the filter from the intake vent and rinse it with warm water.



Wipe off any dust and debris from the grilles or vents using a damp cloth. Set aside to dry as needed.

Clean your heater regularly to remove dust and debris. DO NOT use detergent, solvents, or other such chemicals to clean it.

7

PROGRAMMING  
SETTINGS

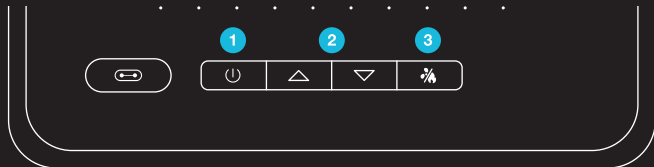

1. POWER BUTTON

Turns your heater ON/OFF. First-time use defaults to level 6; subsequent uses restore the previous setting.

2. UP/DOWN BUTTONS

Adjusts the level up/down between levels 1-10.

3. MODE BUTTON

Toggles between HEAT and FAN mode. HEAT mode is indicated by orange lights; FAN mode is indicated by white lights.

FACTORY RESET

Hold the power and up buttons for 3 seconds to reset your heater and restore factory settings.



MUTE SOUND

Hold the up and down buttons for 2 seconds to mute/unmute sound.



8

PROGRAMMING  
ALARMS

NO LONGER UPRIGHT

An alarm will sound, and the lights will flash whenever your heater falls or is tilted past a 20° angle. Your heater will pause programming until it is back to an upright position.

OVERHEAT PROTECTION

An alarm will sound, programming will pause, and the first 5 lights will flash whenever your heater overheats. If this happens, turn off your heater, unplug it, and let it sit until it cools before restarting it.

If issues persist, contact our customer service department at [support@acinfinity.com](mailto:support@acinfinity.com) or (626) 923-6399 for product and warranty assistance.

9

PROGRAMMING  
ADVANCE PROGRAMMING

This heater is compatible with specific controller models. Please visit our website [www.acinfinity.com](http://www.acinfinity.com) for more information.

EXTENSION CABLE

Use the included UIS M-M extension cord to connect your heater to your controller (not included).

Your controller will override all onboard settings, assume control (parameters must be adjusted on your controller), and shut off your heater's button functions when connected in this manner.

This port can only be used by the UIS extension cord and cannot be connected to any sensor. If you wish to use sensor functions, the only sensor that can be used is the one directly connected to your smart controller.

The port must be dry and capped when not in use to keep liquid and debris out.

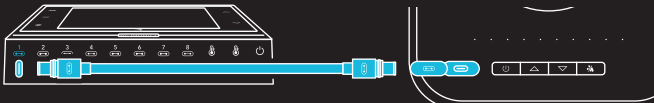

CONTROLLER AI+ shown

10

MORE INFORMATION

PROGRAMMING



For in-depth programming instructions, scan this QR code to view a digital manual.

WARRANTY

Our warranty program is our commitment to you, the original customer, that product sold by AC Infinity Inc. Will be free from defects for TWO YEARS from the date of purchase. If you have any issues with this product, contact us and we'll happily resolve your problem or issue a full refund!



WEBSITE | [www.acinfinity.com](http://www.acinfinity.com)  
EMAIL | [support@acinfinity.com](mailto:support@acinfinity.com)  
PHONE | 626-923-6399, 9 am to 5 pm PST  
ADDRESS | 21880 BAKER PARKWAY  
CITY OF INDUSTRY, CA 91789

DEALERS  
EMAIL | [dealers@acinfinity.com](mailto:dealers@acinfinity.com)  
PHONE | 626-838-4656, 9 am to 5 pm PST

MANUAL CODE SFS2510X1

COPYRIGHT © 2025 AC INFINITY INC. ALL RIGHTS RESERVED

No part of the materials including graphics or logos available in this booklet may be copied, photocopied, reproduced, translated or reduced to any electronic medium or machine-readable form, in whole or in part, without specific permission from AC Infinity Inc.

11

THERMOFORGE S7  
QUICK START GUIDE

AC INFINITY